

DBI 2X6 IF TALLER THAN 14'-0"
TO UNDERPINE OF VAULTED END TRUSS
BALLOON FRAMED CARF END WALL

WINDOW IN
GARAGE GABLE
SEE FRT. ELEV.
2030 FIXED
R.O. 2'-0"x3'-0"

VERIFY ALL WINDOW
R.O. WITH ANDERSEN 100
WINDOW SUPPLIER

MAIN FLR PLAN
SCALE 1/4"=1'
9'-1-1/8" PALTE

PROGRESSIVE PLAN
DESIGN LLP
RESIDENTIAL ARCHITECTURE
(507) 775-6877
714 COUNTY RD. 3 N.W. BYRON MN. 55920
progressiveplan@gmail.com

These drawings have been prepared using information provided by the customer/contractor. The customer/contractor is responsible for providing accurate information. The architect/contractor is not responsible for any errors or omissions in the drawings. The architect/contractor is not responsible for any construction methods or materials used in the construction of the project. The architect/contractor is not responsible for any construction methods or materials used in the construction of the project. The architect/contractor is not responsible for any construction methods or materials used in the construction of the project.

CONTRACTOR: BICELOW/LENNON
OWNER: BL-359

DATE	DESCRIPTION
06-04-19	R.B.
1,574.00	
1911412	
1/4"=1'	

Approved by: _____ Customer/Contractor Signature _____ Date _____

MARTIN BUSTAD
FIRST ADDITION
TO THE CITY OF AUSTIN
COUNTY OF MOWER STATE OF MINNESOTA

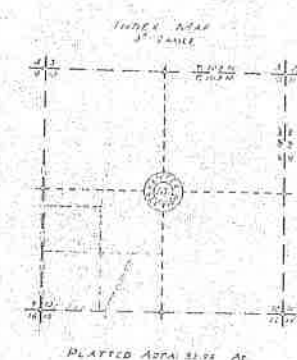
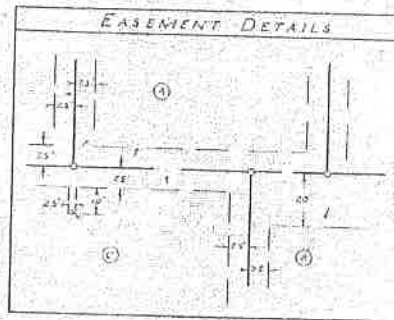

Scale: 1"=200'
C. W. Jones
Civil Engineer & Land Surveyor
Albert Lea, Minn.
May 1922

Legend
 - - - - - Iron stake monument
 - - - - - Subdivision corner
 - - - - - Subdivision boundary
 - - - - - Easement - see details
 - - - - - Locust marker
 90° Angle

E CURVE DATA

ORDER	A	B	C	D	E
1	36.00	100	100.0000	100.00	100.00
2	36.00	100	100.0000	100.00	100.00
3	36.00	100	100.0000	100.00	100.00

OFFICE OF THE REGISTRAR OF TITLES
State of Minnesota
County of Mower
I hereby certify that the above instrument was filed in this office on the 27 day of June AD 1922 at 12:00 P.M. A. M. Jones, Registrar of Titles
By: [Signature] Deputy Registrar of Titles

CITY OF AUSTIN	ORD. NO.	DATE
Annexation		
Plat		
APPROVALS		
Mayor		
City Engineer		
City Recorder		
FILED FOR RECORD		
CERTIFICATES	BOOK	PAGE
Annexation	1416	322
Successors	716	303
City Recorder's	216	30
Registrar of Deeds		

I hereby certify that these for the year 1922, on the land described within are paid.
[Signature]
Registrar of Deeds